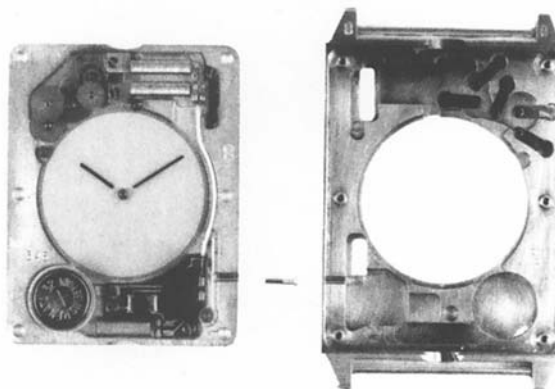

CALIBRE
1355
R Q CORH CORM

**GENERALITIES :**

DISPLAY analogical with discs (hand = transferred index)

FUNCTIONS hours, minutes

CORRECTION entirely electronic by means of a pusher located in the case-frame : hours, minutes, time zone, synchronization.

VARIATION DURING WEAR

better than 30 sec. per month (adjusted to this precision if necessary)

RUNNING TIME 1 Year

CONSUMPTION maxi 0,5 μ A

MINIMUM FUNCTIONING VOLTAGE
1,15V

LAUNCHING DATE 1980

LENGTH OF CASE 40,00 mm

WIDTH " " 27,00 mm

THICKNESS " 1,48 mm

MAINTENANCE

In view of the lack of interchangeability of the component parts of the calibre 1355 watch, which are all adjusted individually by hand, only the replacement of the battery and the bracelet is handled by the General Agent and under specific conditions. All other repairs will be made by the factory only.

BATTERY REPLACEMENT

Authorized to open the watch (sealed screws) are those watchmakers who have been specifically trained by our technical advisers and who thus have available the necessary tools and information as well as the replacement batteries. The battery replacement is free of charge for the customer for a period of 10 years from the date of purchase.

BRACELET REPLACEMENT

The thinness of the calibre 1355 watch required a specially thin bracelet with a special fastener.

After cutting the old bracelet near the soldered lug, insert the tongue of the new bracelet between the case and the lug, coat it with "Néoprène" glue and fold it back, pressing hard for a few seconds. Let it dry several hours.

BATTERY

TYPE silver oxide - zinc low drain

DIAMETER 6.80 mm

HEIGHT 1.10 mm

VOLTAGE 1,55 v

CAPACITY 5 mAh

REFERENCES SSIH 9927

ELECTRONIC MODULE

RESONATOR TYPE quartz tuning fork

FREQUENCY 32768 Hz

FREQUENCY CORRECTOR :

TYPE graphite receptive capacity

MOTOR

TYPE electromagnetic with radial field, plane, step by step (2 steps per revolution)

CONCEPTION integrated, cannot be dismantled

CALIBRE
1355
R Q CORH CORM

This newly designed watch has been developed and assembled by OMEGA. Its various components are grouped in the back of the case, the traditional hands are replaced by discs with indexes, the time-setting is totally electronic.

In view of its extreme thinness (1.48 mm including case), all components are adjusted individually for each watch. Consequently, they are not interchangeable.

Only the battery replacement operation may be effected by the agent. For this purpose, the following instructions must be strictly adhered to.

REPLACEMENT OF BATTERY
BATTERY SSIH NO 9927

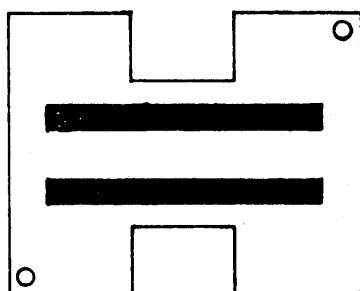

1.0

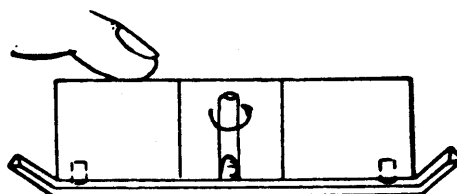

1.2

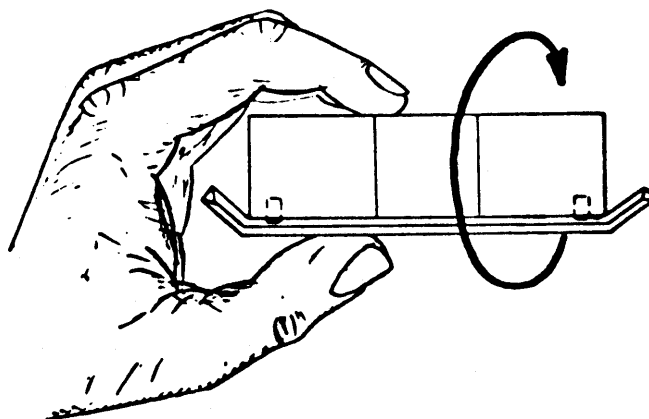

1.3

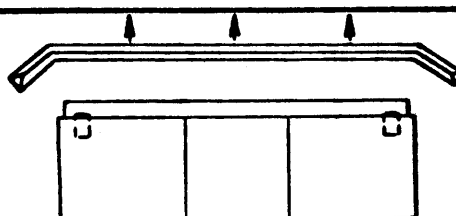

1.4

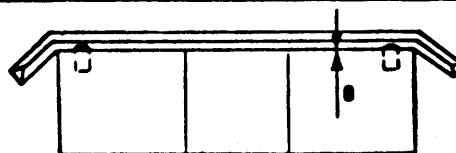

1.7

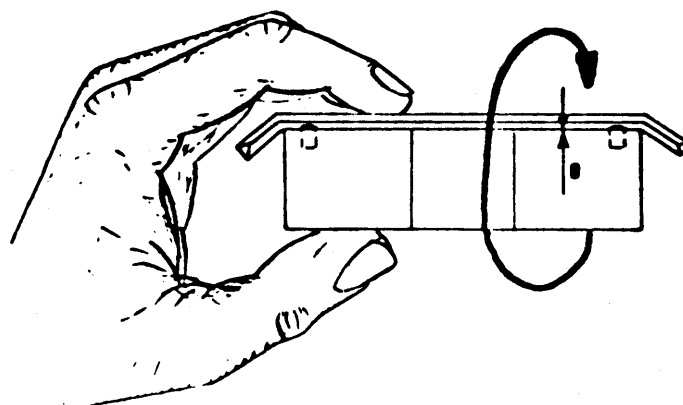

1.9

REPLACEMENT OF BATTERY
BATTERY SSIH NO 9927

WARNING

The wheels and pinions are fixed freely in the back.
So as not to cause accidental dismantling of the movement, proceed only in the following manner.

REMARK

To improve protection against dust, a blue protective cellulose varnish was originally applied between the back and the front part of the watch after screwing on the back. Therefore, to remove the back, the special movement holder of caliber 1355 must be covered with 2 strips of fine, double-faced adhesive paper, applied as in illustration 1.0.

No	OPERATIONS	REMARKS
1.1	Unscrew and remove the 4 screws located in the 4 corners of the back	do not unscrew the 2 central screws
1.2	Place the special movement-holder, turned over, on the back (with 2 adhesive strips), making the 2 pins fit into the corresponding recesses. Grip the movement-holder and unscrew the 2 central screws.	
1.3	Turn the watch and movement-holder over together	
1.4	Lift very carefully the front-part of the case : all the components must remain in the back. Remove all the varnish surplus from the back and the front.	Should some components by accident no longer be in place, these must be assembled in the numerical order shown on Page 6
1.5	Change the battery and check the axial clearance of the new battery in its recess.	(+) side up, gasket up
1.6	Check all the points indicated on the photo on Page 8	
continuation of these operations, following page		

No	OPERATIONS	REMARKS
1.7	Place the time-setting push button in its recess in the front-part of the case then carefully place it on the case-back. making sure that the two perfectly fit together.	<p>The batteries are delivered to us with a height varying between 0.95 mm and 1.10 mm; it is thus necessary to adapt the bent shape of the negative bridle.</p> <p>With the battery in place, lightly press the movement-holder and front: If this deforms the front where the battery is placed, reduce the tension of the 2 bending points of the negative bridle by means of tweezers.</p> <p>An insufficient tension of the 2 bending points of the negative clamp causes running problems (loss of minutes).</p>
1.8	Whilst gripping the case-middle, press the corrector to check positioning of the hour and minute	if the positioning is not correct, refer to the order of operations "2. assembling"
1.9	turn the watch and movement-holder over together	
1.10	screw the 2 central screws	
1.11	remove the movement-holder and screw in the other 4 screws	
1.12	set to time	

2. ORDER OF ASSEMBLING

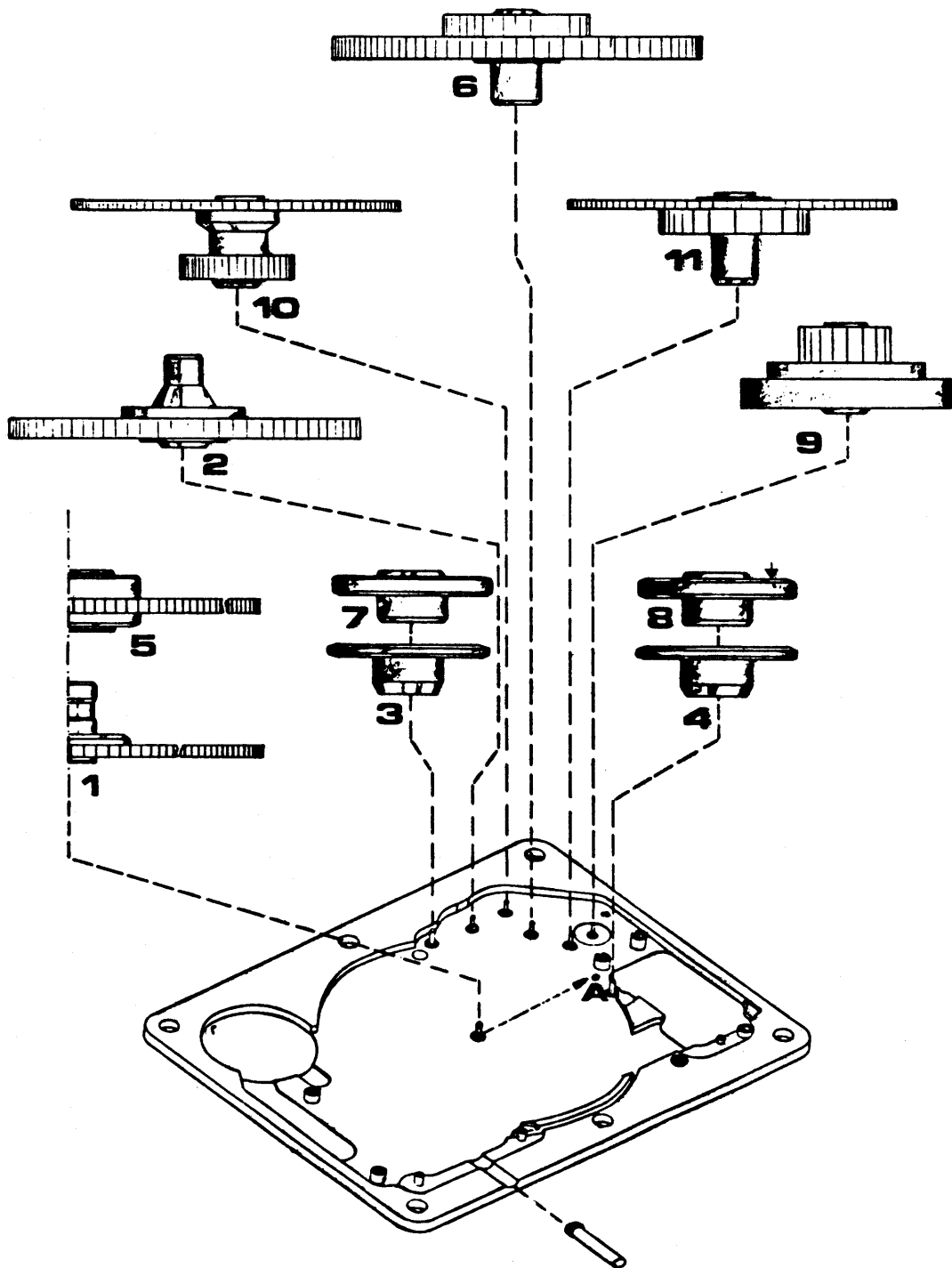

2. ORDER OF ASSEMBLING

No	OPERATIONS	REMARKS	PART No
2.1	hour disc positioned at 12 h.	guide-mark A	1
2.2	hour disc driver		2
2.3	1st hour roller		3
2.4	2nd hour roller		4
2.5	minute disc, positioned at 12 h.	guide-mark A	5
2.6	minute disc driver (check positioning of the hour and minute)	if positioning is incorrect, operate wheels 2 and 6	6
2.7	first minute roller		7
2.8	second minute roller with guide-mark	do not interchange the 2 rollers 7 and 8	8
2.9	rotor	hold it by the pinion	9
2.10	third wheel	hold the hour driver steadily (2)	10
2.11	intermediate wheel	check positioning of the hour and minute	11

THEN REFER TO OPERATIONS "REPLACEMENT OF BATTERY"